

# Feelers for Dial Gauges and Comparator Gauges

with male thread M 2,5

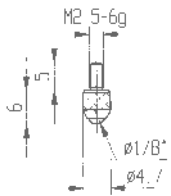

**M2/70**

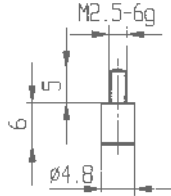

**573/10**

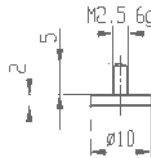

**573/11**

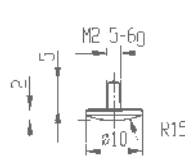

**573/12**

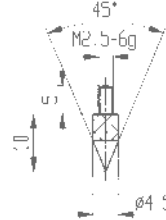

**573/13**

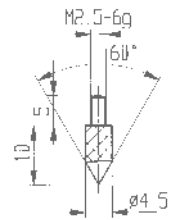

**573/13-60**

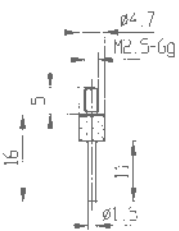

**573/14**

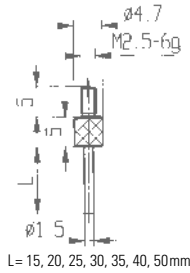

**573/14 L**

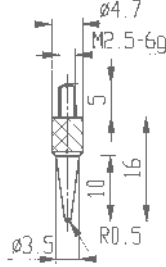

**573/15**

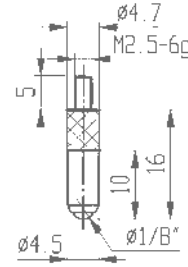

**573/16**

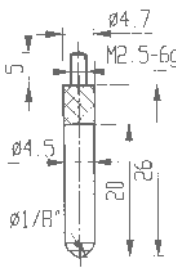

**573/17**

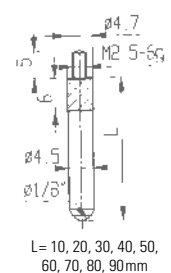

**573/17 L**

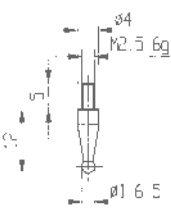

**573/18**

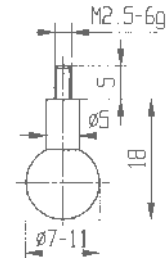

**573/19**

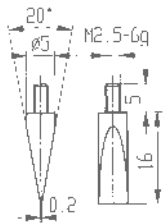

**573/20**

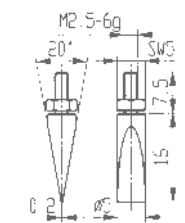

**573/20 E**

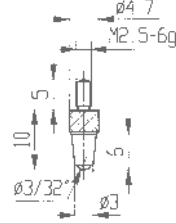

**573/21**

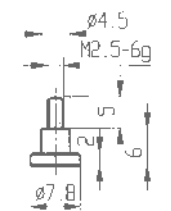

**573/22**

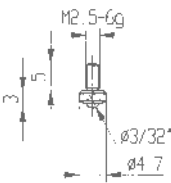

**573/23**

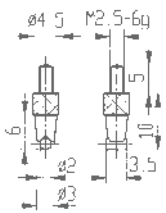

**573/24**

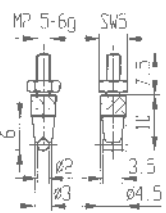

**573/24 E**

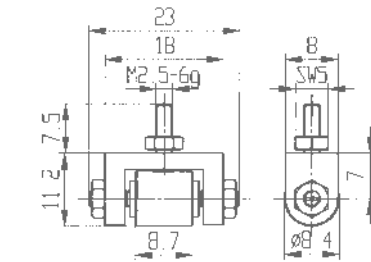

**573/25 E**

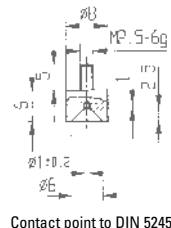

Contact point to DIN 52450

**573/26**

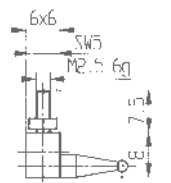

**573/27 E\***

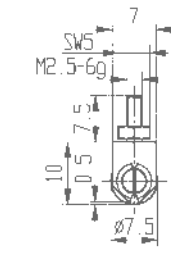

**573/28 E**

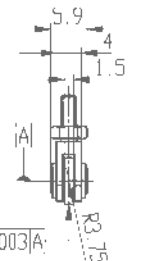

L= 3, 5, 8, 10, 12, 15, 20mm

**573/29 L**

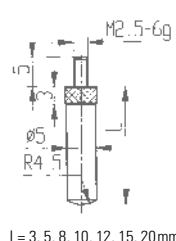
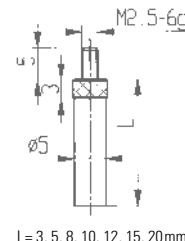

L= 3, 5, 8, 10, 12, 15, 20mm

**573/30 L**

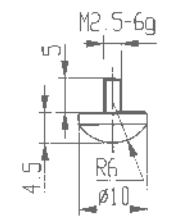

**573/32**

\*available with thread M 2,5 for feelers 573/18 Ø 1-6 mm or with thread M 1,6 for feelers for Dial Test Indicators (see page 88)

## Extensions for feelers

### Feelers with carbide, ruby or sapphire inserts for Dial Gauges and Comparator Gauges

with male thread M 2,5

#### Extensions for feelers

Dimension A: 4 mm (used at Dial Gauges with spindle Ø of 4 mm)

Dimension A: 5 mm (used at Dial Gauges with spindle Ø of 5 mm)

Dimension B available in the following standard lengths:

10, 15, 20, 25, 30, 35, 40, 45, 50, 55, 60, 65, 70, 75, 80, 85, 90, 95 and 100 mm

Special lengths are available

Feelers with carbide (H), ruby (R) or sapphire (S) inserts

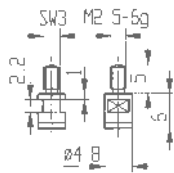
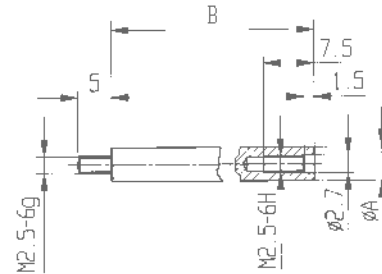

573/10 H

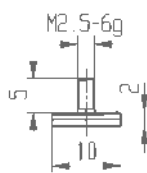

573/11 H

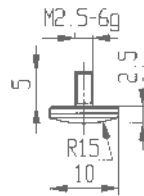

573/12 H

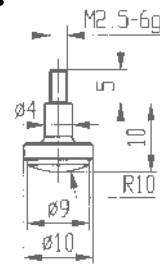

573/12-10 H

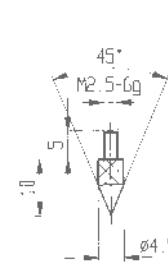

573/13 H

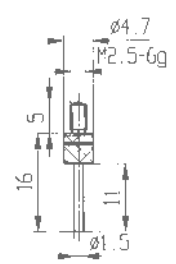

573/14 H

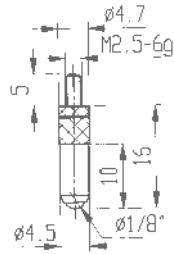

573/16 H

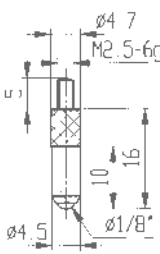

573/16 R/S

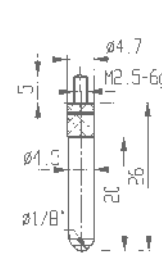

573/17 H

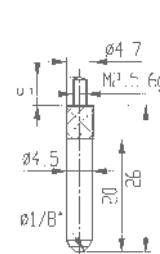

573/17 R/S

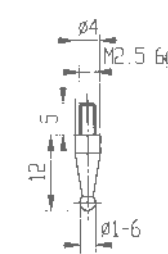

573/18 H

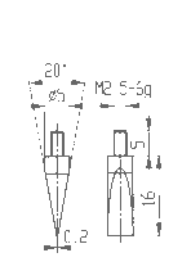

573/20 H

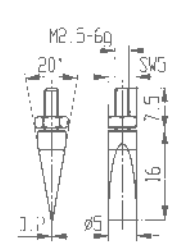

573/20 HE

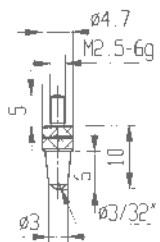

573/21 H

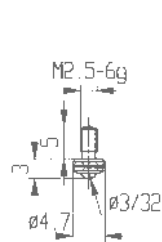

573/23 H

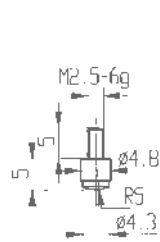

573/31 H

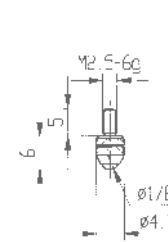

M2/70 H

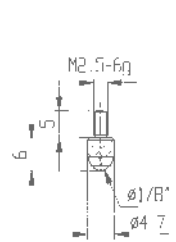

M2/70 R/S

# Feelers for Dial Gauges

with male thread 4/48 NF

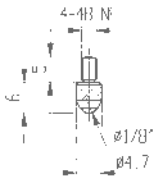

**M2/70 Z**

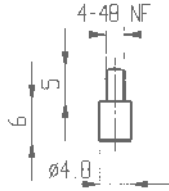

**573/10 Z**

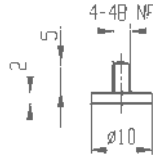

**573/11 Z**

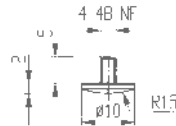

**573/12 Z**

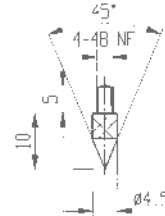

**573/13 Z**

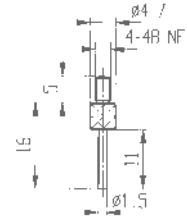

**573/14 Z**

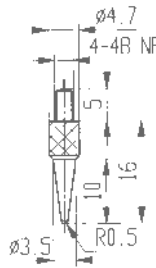

**573/15 Z**

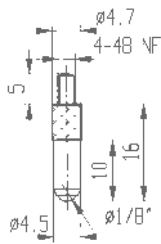

**573/16 Z**

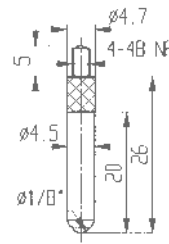

**573/17 Z**

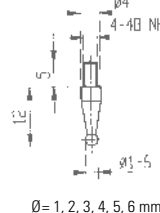

Ø = 1, 2, 3, 4, 5, 6 mm

**573/18 Z**

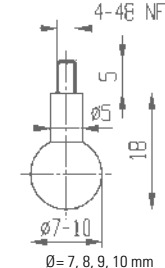

Ø = 7, 8, 9, 10 mm

**573/19 Z**



**573/20 Z**

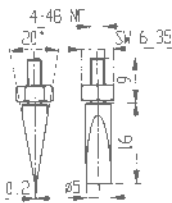

**573/20 ZE**

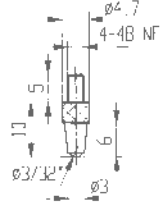

**573/21 Z**

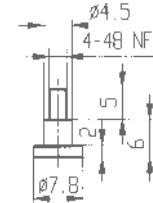

**573/22 Z**

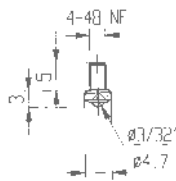

**573/23 Z**

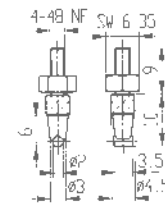

**573/24 ZE**

## Extensions for feelers

### Feelers with carbide (HZ), ruby (RZ) or sapphire (SZ) inserts for Dial Gauges

with male thread 4/48 NF

#### Extensions for feelers

Dimension L available in the following standard lengths:  
 1"=25,4 mm, 2"=50,8 mm, 3"=76,2 mm, 4"=101,6 mm

Special lengths are available

#### Feelers with carbide (HZ), ruby (RZ) or sapphire (SZ) inserts

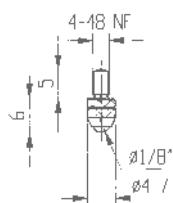
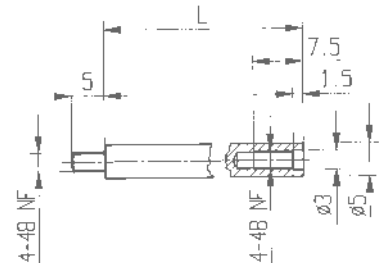

M2/70 HZ

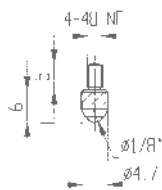

M2/70 RZ/SZ

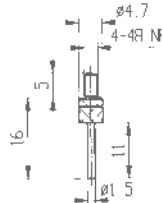

573/14 HZ

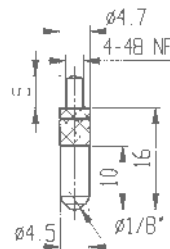

573/16 HZ

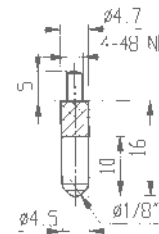

573/16 RZ/SZ

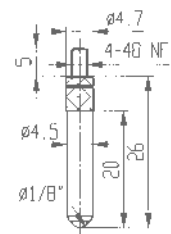

573/17 HZ

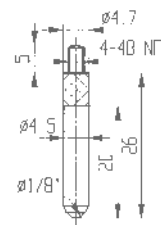

573/17 RZ/SZ

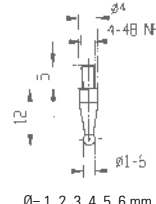

ø= 1, 2, 3, 4, 5, 6 mm

573/18 HZ

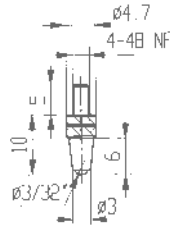

573/21 HZ

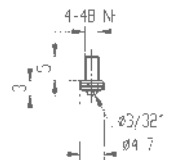

573/23 HZ

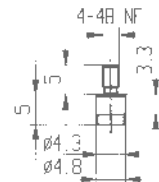

573/101 HZ

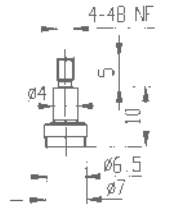

573/102 HZ

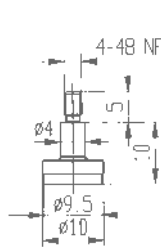

573/103 HZ

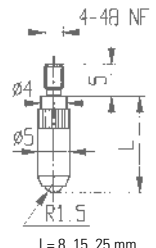

L= 8, 15, 25 mm

573/104 HZ L

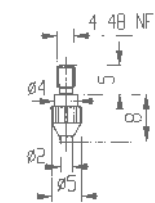

573/105 HZ

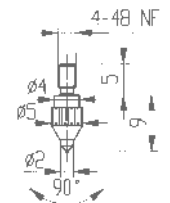

573/106 HZ

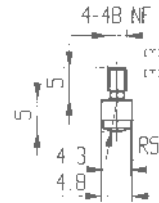

573/107 HZ

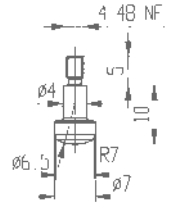

573/108 HZ

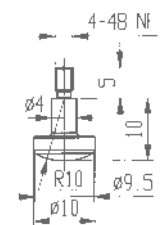

573/109 HZ

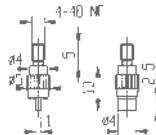

573/110 HZ-1

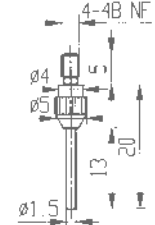

573/111 HZ

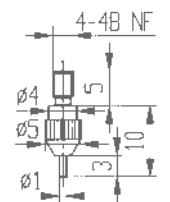

573/112 HZ-1

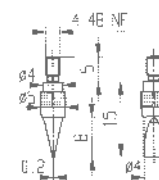

573/113 HZ

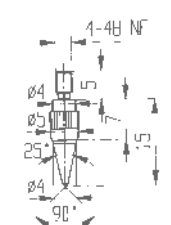

573/114 HZ